

enclosures:
 size "21.21" page:

insulating type 201 - 202
 metallic type 203 - 205
 aggressive environments 325
 EMC 343
 IP68 372 - 373

- can be mated with CKS inserts

¹⁾ the female inserts can be mounted into the straight bulkhead housings CK I from the rear

**inserts, 3 poles + ⊕
 screw terminal connections**



silver plated contacts

**inserts, 4 poles + ⊕
 screw terminal connections**



silver plated contacts

description	part No.	part No.	part No.	part No.
distinctive colour female inserts with female contacts ¹⁾ male inserts with male contacts	white CKF 03 CKM 03	black CKF 03 N CKM 03 N		
distinctive colour female inserts with female contacts ¹⁾ male inserts with male contacts			white CKF 04 CKM 04	black CKF 04 N CKM 04 N

- characteristics according to EN 61984:
10A 250V 4kV 3
10A 230/400V 4kV 2
- UL, CSA, CCC, GL, GOST certified
- rated voltage according to UL/CSA: 600V
- insulation resistance: ≥ 10 GΩ
- ambient temperature limit: -40 °C ... +100 °C
- are made of self-extinguishing thermoplastic resin UL 94 V1
- mechanical life: ≥ 500 cycles
- contact resistance: ≤ 1 mΩ
- for maximum current load, see the following load curves inserts, for more information see page 492

dimensions in mm

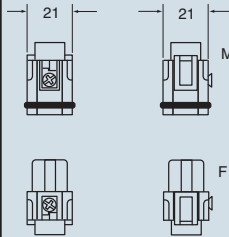

contacts side (front view)



dimensions in mm

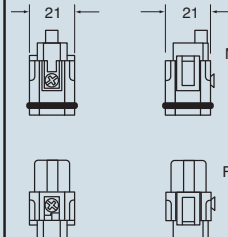

contacts side (front view)

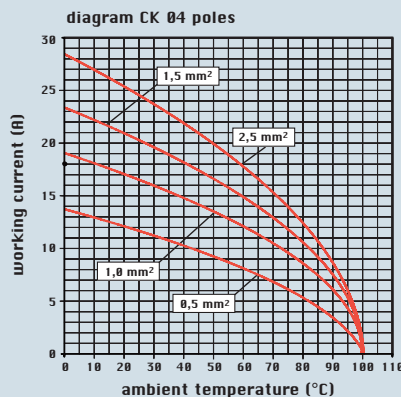
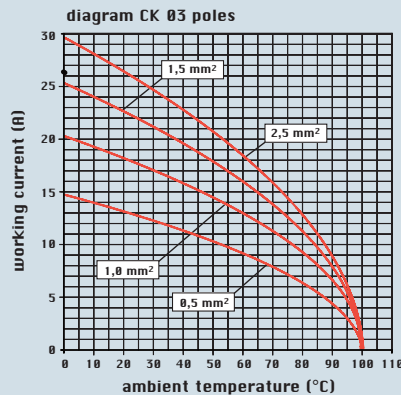

dimensions shown are not binding and may be changed without notice

- inserts for connectors with the following sections: 0.75 - 2.5 mm² - AWG 18 - 14
- conductors stripping length: 6 mm
- terminal screw torque: 0.5 Nm (4.4 lb.in), for more information see page 21 and 22

- inserts for connectors with the following sections: 0.75 - 2.5 mm² - AWG 18 - 14
- conductors stripping length: 6 mm
- terminal screw torque: 0.5 Nm (4.4 lb.in), for more information see page 21 and 22

enclosures:
size "21.21" page:

insulating type	201 - 202
metallic type	203 - 205
aggressive environments	325
EMC	343
IP68	372 - 373

- can be mated with CK inserts

**inserts, 3 poles + ⊕
 connection with spring terminal**



silver plated contacts

**inserts, 4 poles + ⊕
 connection with spring terminal**



silver plated contacts

description

part No.

part No.

female inserts with female contacts
 male inserts with male contacts

**CKSF 03
 CKSM 03**

female inserts with female contacts
 male inserts with male contacts

**CKSF 04
 CKSM 04**

- characteristics according to EN 61984:
10A 400V 4kV 3
- certifications: cUL (UL for USA and Canada), CSA, CCC, GOST
- rated voltage according to UL/CSA: 600V
- insulation resistance: $\geq 10 \text{ G}\Omega$
- ambient temperature limit: $-40 \text{ }^\circ\text{C} \dots +125 \text{ }^\circ\text{C}$
- are made of self-extinguishing thermoplastic resin UL 94 V0
- mechanical life: ≥ 500 cycles
- contact resistance: $\leq 1 \text{ m}\Omega$
- for maximum current load, see the following load curves inserts, for more information see page 492

dimensions in mm

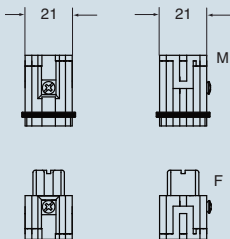

contacts side (front view)



- inserts for wires with the following sections:
 0.14 - 2.5mm² - AWG 26 - 14
 for prepared wires
 usable section: up to 1.5 mm² (AWG 16)
- conductors stripping length: 9...11 mm

dimensions in mm

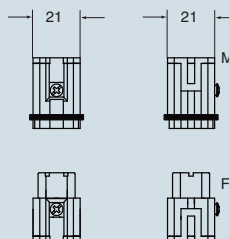

contacts side (front view)

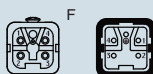

- inserts for wires with the following sections:
 0.14 - 2.5mm² - AWG 26 - 14
 for prepared wires
 usable section: up to 1.5 mm² (AWG 16)
- conductors stripping length: 9...11 mm

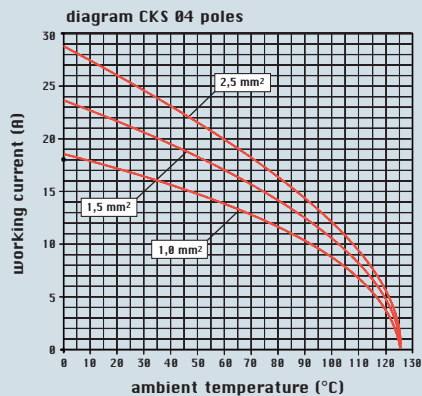
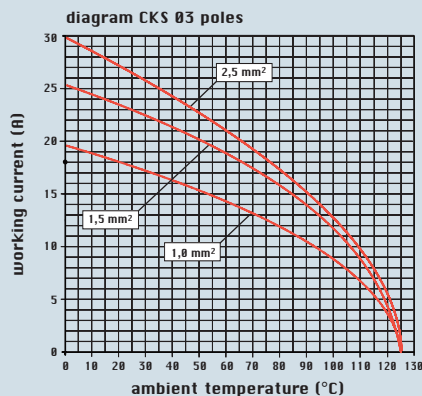

dimensions shown are not binding
 and may be changed without notice

Connection with spring terminal

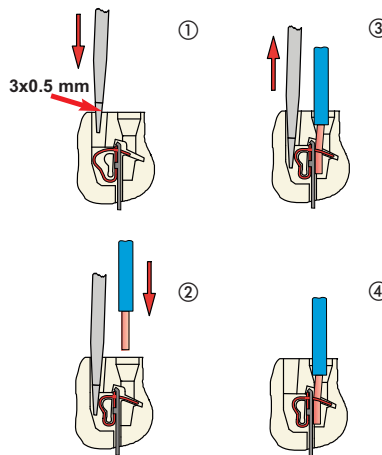

Rear top entry of wires for a more easier wiring

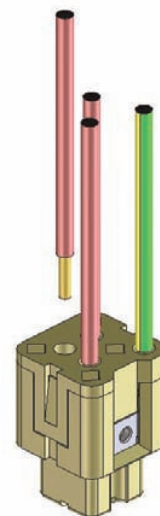

ENCLOSURE CHARACTERISTICS



Series	Locking device	Variant	IP (EN 60529) ²⁾	UL 50 Type (NEMA 250 Type)	Environmental temperature range	from page
CK/MK	single		IP44	12	-40 °C ÷ +125 °C	201
		with CKR 65 (D)	IP66/IP67, IP69K ³⁾	12, 4, 4X	-40 °C ÷ +125 °C	
CKA/MKA CKAX/MKAX	single		IP44	12	-40 °C ÷ +125 °C	203
		with CKR 65 (D)	IP66/IP67, IP69K ³⁾	12, 4, 4X	-40 °C ÷ +125 °C	
CKG/MKG CKAG/MKAG	single	for CXL, CJ K and CX 1/2 BD inserts	IP66/IP67, IP69K ³⁾	12, 4, 4X	-40 °C ÷ +125 °C	459
CGK/MGK	screw		IP68, IP69K ³⁾		-40 °C ÷ +125 °C	372
CQ	single	with conductive gasket	IP66/IP67, IP69K ³⁾		-40 °C ÷ +125 °C	206
CZ/MZ	single		IP66, IP69K ³⁾	12, 4, 4X	-40 °C ÷ +125 °C	208
	dual					
CH, CA/MH,	single		IP66, IP69K ³⁾	12, 4, 4X ⁴⁾	-40 °C ÷ +125 °C (R -40 °C ÷ 180 °C)	215
	dual					
T-TYPE	single		IP65	12	-40 °C ÷ +90 °C	282
	dual					
V-Type IP67	single (44.27)		IP67, IP69K ³⁾	12, 4, 4X ⁴⁾	-40 °C ÷ +125 °C	254
	dual (57.27, 77.27 104.27)					
V-Type IP66	single		IP66, IP69K ³⁾	12, 4, 4X ⁴⁾	-40 °C ÷ +125 °C	262
JEI	single		IP66		-40 °C ÷ +125 °C	288
	dual					
BIG enclosures	single (44.27)		IP66		-40 °C ÷ +125 °C	304
	dual (57.77, 77.27 104.27)					
CG/MG	screw or bayonet		IP66, IP68, IP69K ³⁾	12, 4, 4X	-40 °C ÷ +125 °C	372
Central Lever	single central lever		IP65		-40 °C ÷ +125 °C	360
COB	dual		IP20		-40 °C ÷ +125 °C	410

²⁾ the enclosures ensure IP protection rating when coupled and locked with the locking lever. The cover (CS, CP) only provides mechanical protection without ensuring the protection rating

standards

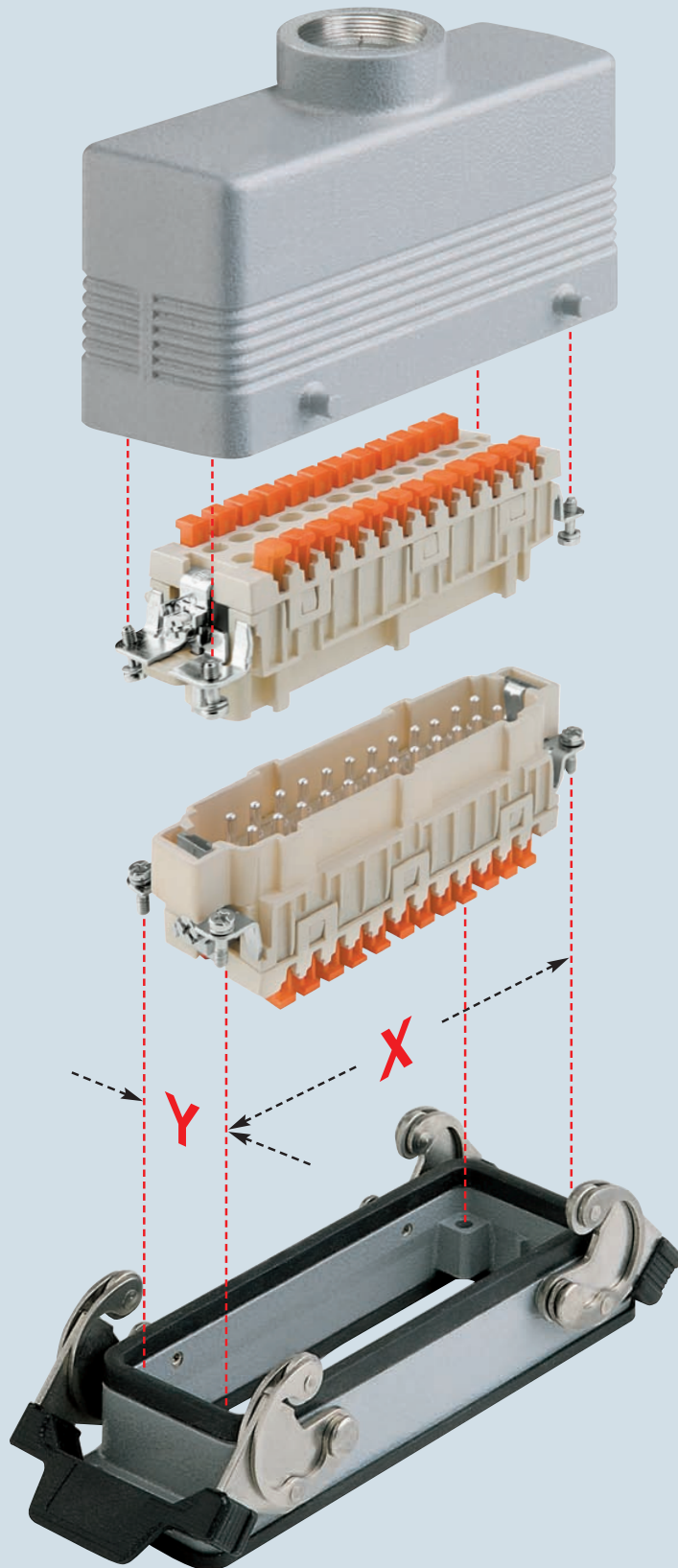

Identification of enclosures

Connector inserts and their enclosures are numerous and therefore the search for the correct pairing of one with another can be complex.

To facilitate this operation (in addition to the normal part number) the definition of "size" has been introduced in this catalogue.

As indicated in the illustration on the left and in the table below the size value refers to the screw fixing centre distances which constitute a unique element since they are common to both the inserts and the enclosures.

All the pages that illustrate combinable articles (inserts and enclosures) carry references as per the examples illustrated on the opposite page.

Following is a table that shows all the sizes of the enclosures and the dimensions of the housings where the inserts will be fastened.

enclosures size	insert housing with screw fixing centre distance x-y
"21.21"	(21 x 21 mm) **
"32.13"	32 x 13 mm
"49.16"	49.5 x 16 mm
"66.16"	66 x 16 mm
"66.40"	66 x 16 mm (2 inserts)
"44.27"	44 x 27 mm
"57.27"	57 x 27 mm
"77.27"	77.5 x 27 mm
"104.27"	104 x 27 mm
"77.62"	77.5 x 27 mm (2 inserts)
"104.62"	104 x 27 mm (2 inserts)

** dimensions relating to the insert cross-section size not being able to identify a screw fixing centre distance since provided with a single screw.



inserts:		page
CK	3 poles + ⊕	40
CK	4 poles + ⊕	40
CKS	3 poles + ⊕	41
CKS	4 poles + ⊕	41
CD	7 poles + ⊕	45
CD	8 poles	46
CQ	5 poles + ⊕	69
CQ	12 poles + ⊕	68

insert dimensions:
21 x 21 mm

bulkhead mounting housings



angled bulkhead mounting housings



description	part no.	part no. (entry - Pg 11)	part no. (entry - M 20)
with lever	CK 03 I (white)		
with lever	CK 03 IN (black)		
without cable gland entry, with lever		CK 03 IA (white)	
without cable gland entry, with lever		CK 03 IAN (black)	
with cable gland entry and lever		CK 03 IAPS (white)	MK IAP20 (white)
with cable gland entry and lever		CK 03 IAPNS (black)	MK IAPN20 (black)
gasket and screw kit for IP66/IP67 ¹⁾ for CK, CQ 05, CKS inserts	CKR 65	CKR 65	
gasket and screw kit for IP66/IP67 ¹⁾ for CD 07/08 inserts	CKR 65 D	CKR 65 D	

panel cut-out for enclosures, in mm

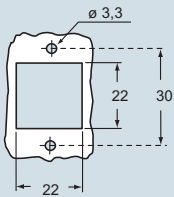

1) To obtain the protection rating IP66/IP67 a kit is provided that includes a gasket to fit under the insert fixing screws supplied with the kit (see illustrative example)
CQ 12 inserts are already supplied with a gasket and screw which ensure IP66/IP67 protection rating

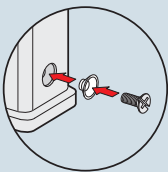

dimensions in mm

CK I(N)

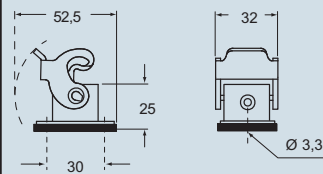

dimensions in mm

CK IA(N)

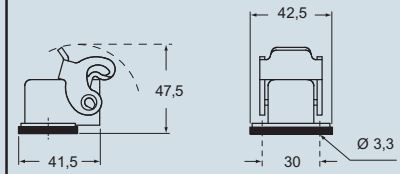

CK IAP(N)S and MK IAP(N)

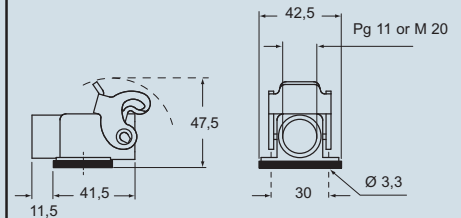

CAUS®
Type 12
Type 4/4X only
with CKR 65 (D)



IP66/IP67 with CKR 65 (D) ¹⁾

dimensions shown are not binding
and may be changed without notice



inserts:		page
CK	3 poles + ⊕	40
CK	4 poles + ⊕	40
CKS	3 poles + ⊕	41
CKS	4 poles + ⊕	41
CD	7 poles + ⊕	45
CD	8 poles	46
CQ	5 poles + ⊕	69
CQ	12 poles + ⊕	68

insert dimensions:
21 x 21 mm

hoods



covers



description	part no. (entry - Pg 11)	part no. (entry - M 20)	part no.
with pegs, top entry	CK 03 VS (white)	MK V20 (white)	
with pegs, top entry	CK 03 VNS (black)	MK VN20 (black)	
with pegs, side entry	CK 03 VAS (white)	MK VA20 (white)	
with pegs, side entry	CK 03 VANS (black)	MK VAN20 (black)	
with lever, top entry	CK 03 VGS (white)	MK VG20 (white)	
with lever, top entry	CK 03 VGNS (black)	MK VGN20 (black)	
with pegs and gasket, for female inserts			CK 03 C (white)
with pegs and gasket, for female inserts			CK 03 CN (black)
with pegs, for male inserts			CK 03 CA (white)
with pegs, for male inserts			CK 03 CAN (black)
with lever and gasket, for female inserts			CK 03 CX (white)
with lever and gasket, for female inserts			CK 03 CN (black)
with lever, for male inserts			CK 03 CXA (white)
with lever, for male inserts			CK 03 CXAN (black)
gasket and screw kit for IP66/IP67 ¹⁾ for CK, CQ 05, CKS inserts	CKR 65		
gasket and screw kit for IP66/IP67 ¹⁾ for CD 07/08 inserts	CKR 65 D		

1) To obtain the protection rating IP66/IP67 a kit is provided that includes a gasket to fit under the insert fixing screws supplied with the kit (see illustrative example)
CQ 12 inserts are already supplied with a gasket and screw which ensure IP66/IP67 protection rating

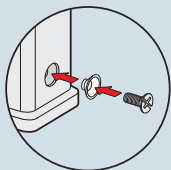

dimensions in mm

CK V(N)S and MK V(N)

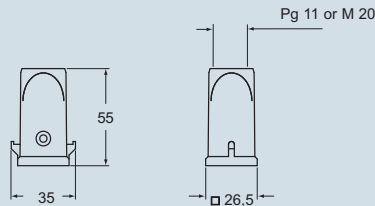

CK VA(N)S and MK VA(N)

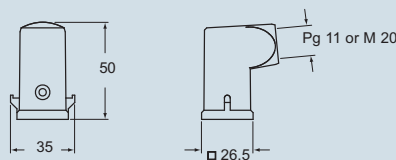

CK VG(N)S and MK VG(N)

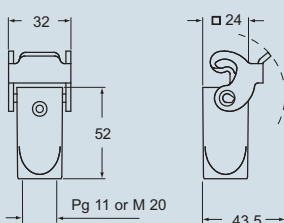

dimensions in mm

CK C(N)

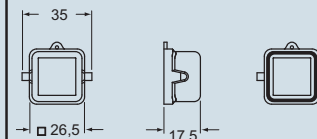

CK CA(N)

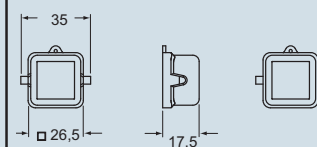

CK CX(N)

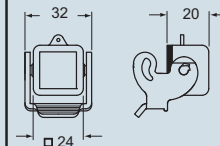

CK CXA(N)

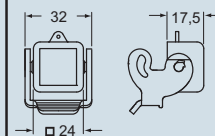

RAUS® Type 12
Type 4/4X only
with CKR 65 (D)



IP66/IP67 with CKR 65 (D) ¹⁾

dimensions shown are not binding
and may be changed without notice



inserts:		page
CK	3 poles + ⊕	40
CK	4 poles + ⊕	40
CKS	3 poles + ⊕	41
CKS	4 poles + ⊕	41
CD	8 poles	46
CQ	5 poles + ⊕	69
CQ	12 poles + ⊕	68

insert dimensions:
21 x 21 mm

bulkhead mounting housings



angled bulkhead mounting housings



description	part no.	part no.	
		(entry - Pg 11)	(entry - M 20)
with galvanised steel lever with stainless steel lever	CKA 03 I CKAX 03 I		
without cable gland, galvanized steel lever without cable gland, stainless steel lever		CKA 03 IA CKAX 03 IA	
with cable gland, galvanized steel lever with cable gland, stainless steel lever with cable gland, galvanized steel lever, bulkhead hole closed with cable gland, stainless steel lever, bulkhead hole closed		CKA 03 IAPS CKAX 03 IAPS CKA 03 APS CKAX 03 APS	MKA IAP20 MKAX IAP20 MKA AP20 MKAX AP20
gasket and screw kit for IP66/IP67 ¹⁾ for CK, CQ 05, CKS inserts	CKR 65	CKR 65	
gasket and screw kit for IP66/IP67 ¹⁾ for CD 07/08 inserts	CKR 65 D	CKR 65 D	

panel cut-out for enclosures, in mm

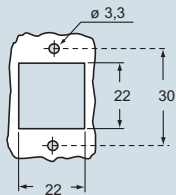

1) To obtain the protection rating IP66/IP67 a kit is provided that includes a gasket to fit under the insert fixing screws supplied with the kit (see illustrative example)
CQ 12 inserts are already supplied with a gasket and screw which ensure IP66/IP67 protection rating

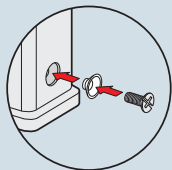

dimensions in mm

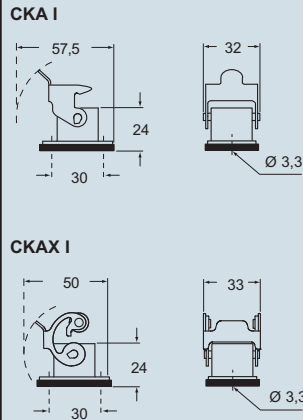

dimensions in mm

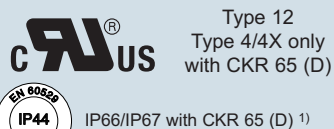
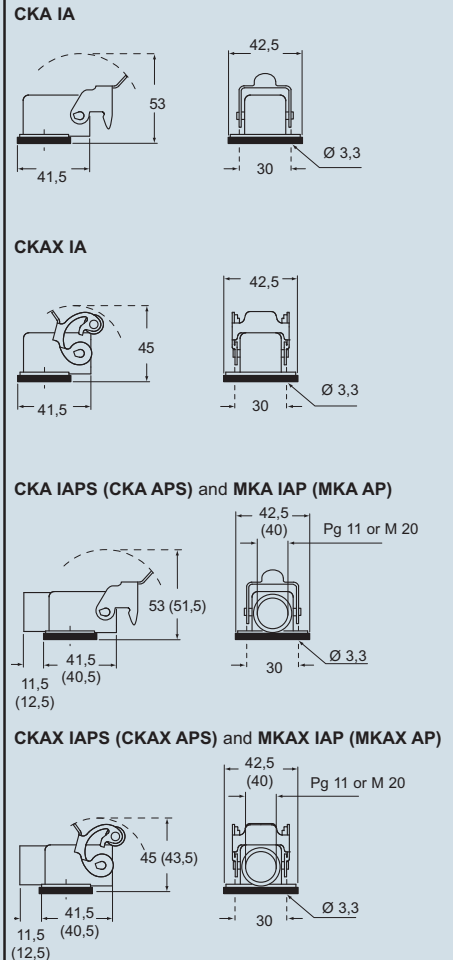

dimensions shown are not binding
and may be changed without notice