

Line robot – for vertical working planes



- **x-axis:** drylin® GRW-0630 rack and pinion drive with NEMA17 stepper motor with encoder
- **y-axis:** drylin® ZLW-1080 toothed belt axis with NEMA23 stepper motor with encoder
- Proximity switches available

Technical data

Workspace:	500 x 100mm
Max. speed:	1.0m/s
Max. acceleration:	3.0m/s ²
Repeatability:	0.2mm
Load capacity:	25N



Part No.
DLE-LG-0001

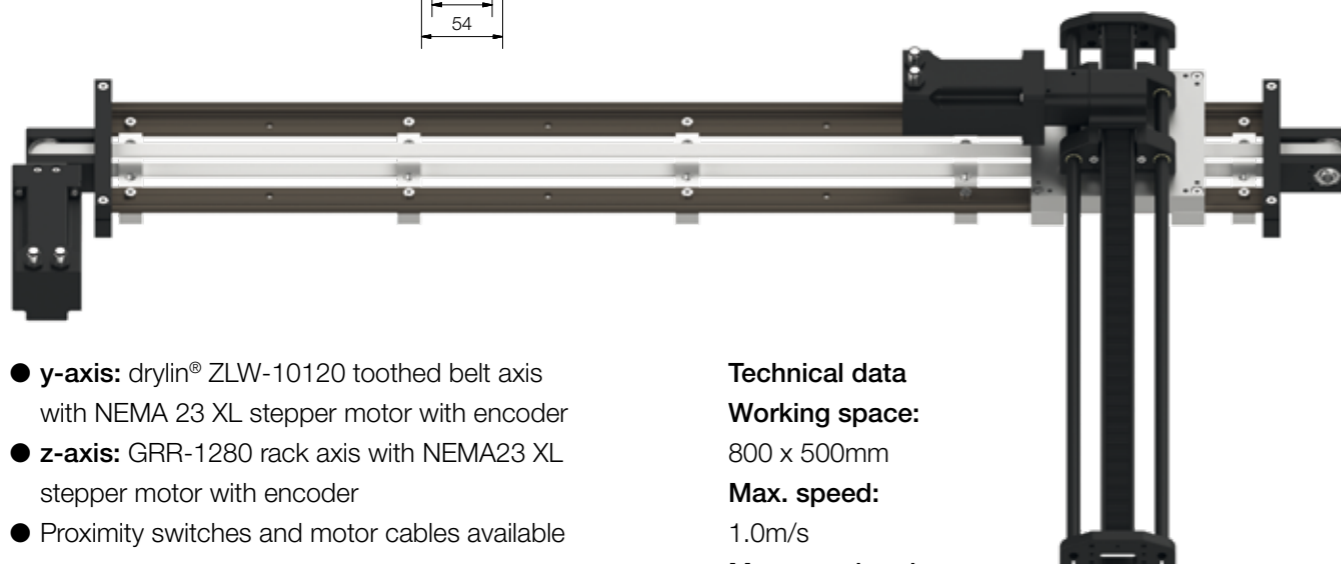
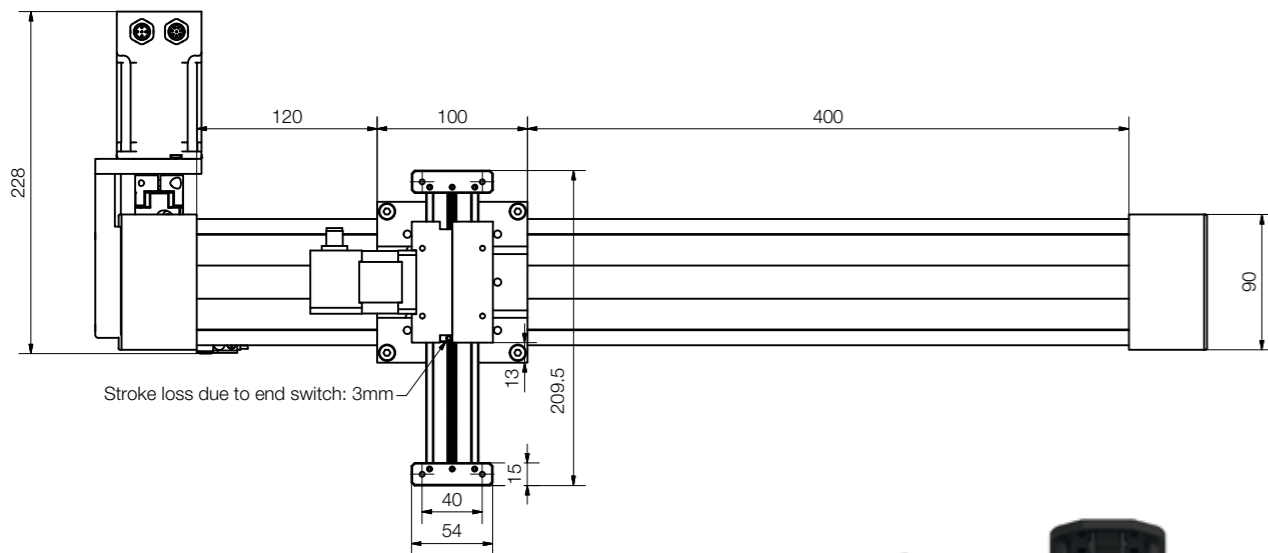

- **y-axis:** drylin® ZLW-10120 toothed belt axis with NEMA 23 XL stepper motor with encoder
- **z-axis:** GRR-1280 rack axis with NEMA23 XL stepper motor with encoder
- Proximity switches and motor cables available

Technical data

Working space:	800 x 500mm
Max. speed:	1.0m/s
Max. acceleration:	2.0m/s ²
Repeatability:	0.3mm
Load capacity:	50N



Part No.
DLE-LG-0002

Flat linear robot – for predefined surfaces

**DLE-FG-0001**

- **x-axis:** drylin® ZLW-0630 toothed belt axis with NEMA17 stepper motor with encoder
- **y-axis:** drylin® ZLW-0630 toothed belt axis with NEMA17 stepper motor with encoder
- Proximity switches available

Technical data

Workspace:	300 x 300mm
Max. speed:	1.5m/s
Max. acceleration:	10m/s ²
Repeatability:	0.3mm
Load capacity:	80N

DLE-FG-0002

- **x-axis:** drylin® ZLW-0630 toothed belt axis with NEMA17 stepper motor with stranded wire
- **y-axis:** drylin® ZLW-0630 toothed belt axis with NEMA17 stepper motor with stranded wire
- Proximity switches available

Technical data

Workspace:	300 x 300mm
Max. speed:	1.5m/s
Max. acceleration:	10m/s ²
Repeatability:	0.3mm
Load capacity:	80N

DLE-FG-0003

- **x-axis:** drylin® ZLW-1040 econ toothed belt axis with NEMA23 stepper motor with stranded wire
- **y-axis:** drylin® ZLW-1040 econ toothed belt axis with NEMA17 stepper motor
- Proximity switches available

Technical data

Workspace:	500 x 500mm
Max. speed:	0.5m/s
Max. acceleration:	1m/s ²
Repeatability:	1mm
Load capacity:	10N

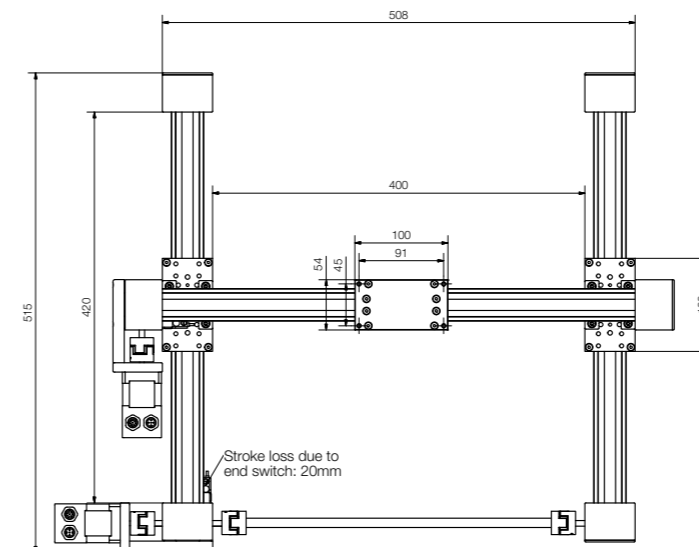

Part No.
DLE-FG-0001 version with encoder
DLE-FG-0002 version with stranded wires
DLE-FG-0003 econ version
► Page 1462