

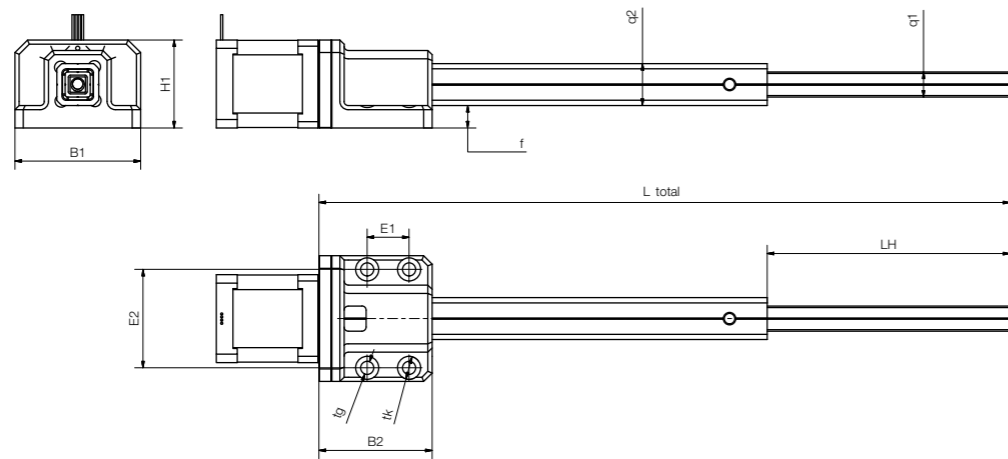

- Extension lengths up to 300mm
- Max. compressive strength 100N
- Unsupported installation
- Accessories available (hand wheel, position indicator etc.)
- Ready-to-connect with drylin® motor kits

Typical application areas:

- Textile industry
- Actuators
- Windows
- Rehabilitation technologies
- Lane adjustments
- Inspection technology
- Medical and pharmaceutical technology



Dimensions [mm]

Part No.	Max. axial F [N]	LH	L Total	H1	B1	B2	E1	E2	Q1	Q2	tk	tg
QLA-2012-A	100	300	B2 + 2xLH	42	60	54	20	47	12	20	11	6.5

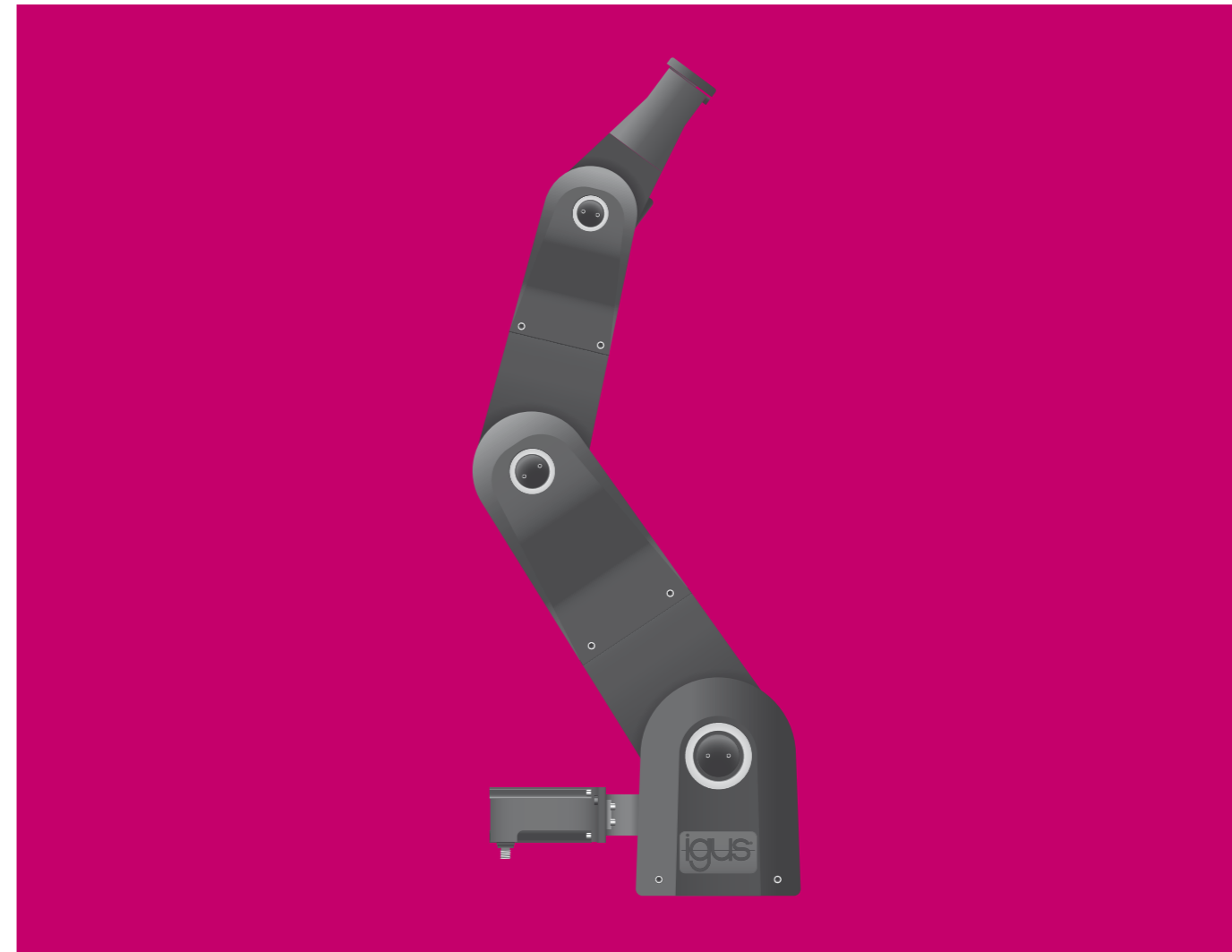

robolink® – polymer-based robot arm

Robot arms

Rotary axes

Apiro® joints

