

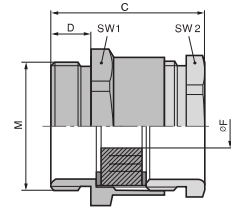

SKINDICHT® SVRN-M / SKINDICHT® SVRE-M

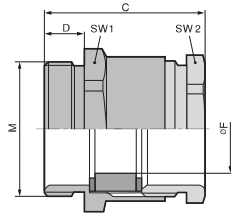

SKINDICHT® SVRN-M

SKINDICHT® SVRE-M

Benefits

SKINDICHT® SVRN-M

- High mechanical stability
- Optimum strain relief

SKINDICHT® SVRE-M

- With incised sealing ring for adjustment to several cable diameters
- Fewer sizes need to be kept in stock

Application range

SKINDICHT® SVRN-M

- Brass cable gland with hexagonal fitting, for fast assembly with a flat spanner.

SKINDICHT® SVRE-M

- Brass cable gland with hexagonal fitting and variable incised sealing ring.

Product Make-up

- Metric connection thread acc. to DIN EN 60423
- Basis for technical information EN 50262

Note

SKINDICHT® SVRN-M

- Counter nut to be used: SKINDICHT® SM-M
- Example order identification: SVRN-M 12 / 7 / 5
12 = Connection thread metric
7 = Function thread PG
5 = Clear width F

SKINDICHT® SVRE-M

- Refer to SKINDICHT® EV for additional accessories
- Counter nut to be used: SKINDICHT® SM-M

Product Make-up

SKINDICHT® SVRN-M

- For connection thread M 50 x 1.5 and M 63 x 1.5, refer to SKINDICHT® SVRE-M

Technical data



Classification

ETIM 5.0 Class-ID: EC000441
ETIM 5.0 Class-Description:
Cable screw gland



Caution

The installation dimensions can be found in appendix T21



On request

SKINDICHT® SVRN-M
Available with long connection thread
SKINDICHT® SVRE-M
Available with long connection thread
Available with VITON® incised ring



Material

SKINDICHT® SVRN-M
Body: nickel-plated brass
Sealing ring: CR/NBR
SKINDICHT® SVRE-M
Body: nickel-plated brass
Incised seal: CR/NBR



Protection rating

SKINDICHT® SVRN-M
IP 54



Temperature range

SKINDICHT® SVRN-M
-20 °C to +100 °C
SKINDICHT® SVRE-M
-20 °C to +80 °C

Article number	Article designation / size	Incised sealing ring ØF (mm)	Max. internal Ø (mm)	Function thread PG	SW1/SW2 mm	Overall length, C (mm)	Thread length, D (mm)	Clear opening F (mm)	Pieces / PU
SKINDICHT® SVRN-M									
52104800	12 x 1,5			7	14 / 13	20.6	5	5	100
52104810	12 x 1,5			7	14 / 13	20.6	5	6	100
52104820	12 x 1,5			7	14 / 13	20.6	5	7	100
52104830	16 x 1,5			9	18 / 15	21.6	5	7	100
52104840	16 x 1,5			9	18 / 15	21.6	5	8	100
52104850	16 x 1,5			9	18 / 15	21.6	5	9	100
52104860	20 x 1,5			11	22 / 18	23.6	6	10	50
52104870	20 x 1,5			11	22 / 18	23.6	6	11	50
52104890	20 x 1,5			13.5	22 / 20	25.6	6	12	50
52104900	20 x 1,5			16	24 / 22	26.6	6	13	50
52104910	20 x 1,5			16	24 / 22	26.6	6	14	50
52104920	25 x 1,5			21	30 / 28	29.6	7	18	50
52104930	32 x 1,5			29	40 / 37	32.6	8	27	50
52104940	40 x 1,5			36	50 / 47	37.6	8	34	20
SKINDICHT® SVRE-M									
52104980	16 x 1,5	5/8	10	9	18 / 15	21.6	5		100
52104990	20 x 1,5	7/10/12.5	12	11	22 / 18	23.6	6		50
52105000	20 x 1,5	7/10.5/13/16	14	13.5	22 / 20	25.6	6		50
52105010	20 x 1,5	8/10.5/13.5/16	15	16	24 / 22	26.6	6		50
52105002	25 x 1,5	11/15/18/20	20	21	30 / 28	29.6	7		50
52105003	32 x 1,5	19/23/27/31	27	29	40 / 37	32.6	8		50
52105004	40 x 1,5	25/28/31/35	34	36	50 / 47	37.6	8		20
52105005	50 x 1,5	35.5/39/42.5/46	43	42	57 / 54	42.6	9		5
52105006	63 x 1,5	40.5/44/47/50.5	48	48	66 / 60	45.1	10		5

Photographs are not to scale and do not represent detailed images of the respective products.
Viton® is a registered trademark of DuPont de Nemours



SKINDICHT® SVRX



SKINDICHT® SVRE-M

SKINDICHT® SVRE-M

Benefits

- EMC version for cables with large cross-sections
- SKINDICHT® SVRX 105 x 2 for cable diameters up to 83 mm

Application range

- The cable gland is in accordance with DIN 89280, with round intermediate supports made from brass, plain.
- Shipbuilding
- Off-Shore
- High-power drives
- Wind power plants

Note

- EMC counter nuts (with claw) SKINDICHT® SM-PE / SVRX M24-M56 for painted, anodised or powder-coated housing on request
- For more EMC cable glands, refer to SKINTOP® MS-SC-M and MS-M BRUSH, and compatible counter nut SKINDICHT® SM-PE-M

Product Make-up

- Type "W" for cable without screen (figure 1)
- Type "Z" for cables with screen (figure 2)

Technical data

	Classification ETIM 5.0 Class-ID: EC000441 ETIM 5.0 Class-Description: Cable screw gland
	Certifications DIN 89280
	Material Body: Blank brass Seal: EPDM
	Protection rating IP 56
	Temperature range -20°C to +80°C

Article number	Article designation / size	Thread	SW wrench size mm	Clear opening F (mm)	Pieces / PU
SKINDICHT® SVRX - version W					
52006460	SVRX 5635	M 56 x 2	55	32 - 35	1
52006470	SVRX 5638	M 56 x 2	55	35 - 38	1
52006480	SVRX 5641	M 56 x 2	55	38 - 41	1
52006490	SVRX 7244	M 72 x 2	70	41 - 44	1
52006500	SVRX 7248	M 72 x 2	70	44 - 48	1
52006510	SVRX 7252	M 72 x 2	70	48 - 52	1
52006520	SVRX 7256	M 72 x 2	70	52 - 56	1
52006530	SVRX 8066	M 80 x 2	85	62 - 66	1
52006540	SVRX 10573	M 105 x 2	104	68 - 73	1
52006550	SVRX 10572	M 105 x 2	104	78 - 83	1
52006564	SVRX 8059	M 80 x 2	85	56 - 59	1
SKINDICHT® SVRX - version Z					
52006345	SVRX 2412	M 24 x 1.5	24	10 - 12	1
52006355	SVRX 2414	M 24 x 1.5	24	12 - 14	1
52006365	SVRX 2416	M 24 x 1.5	24	14 - 16	1
52006375	SVRX 2417	M 24 x 1.5	24	16 - 17	1
52006425	SVRX 3626	M 36 x 2	36	24 - 26	1
52006465	SVRX 5635	M 56 x 2	55	32 - 35	1
52006475	SVRX 5638	M 56 x 2	55	35 - 38	1
52006485	SVRX 5641	M 56 x 2	55	38 - 41	1
52006495	SVRX 7244	M 72 x 2	70	41 - 44	1
52006505	SVRX 7248	M 72 x 2	70	44 - 48	1
52006515	SVRX 7252	M 72 x 2	70	48 - 52	1
52006565	SVRX 8059	M 80 x 2	85	56 - 59	1
52006535	SVRX 8066	M 80 x 2	85	62 - 66	1
52006545	SVRX 10573	M 105 x 2	104	68 - 73	1
SKINDICHT® SM/SVRX Counter nuts					
52006321	SM 24	M24	30		1
52006401	SM 36	M36	41		1
52006461	SM 56	M56	65		1
52006491	SM 72	M72	85		1
52006531	SM 80	M80	90		1
52006541	SM 105	M105	120		1

Photographs are not to scale and do not represent detailed images of the respective products.



SKINDICHT® SVFK-M

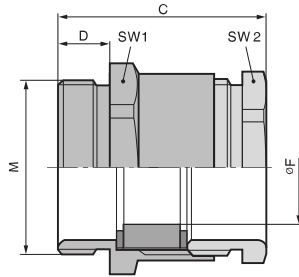

Benefits

- Economical type
- Lateral sealing lips fit automatically around various cable dimensions
- Cable-specific seal dimensions are no longer necessary
- Tolerance
- Large opening allows clamping of up to two flat cables

Application range

- For inserting flat cables
- Conveyor systems
- Pumps
- Lifts
- Control cabinet manufacturing

Product Make-up

- Metric connection thread acc. to DIN EN 60423
- Basis for technical information EN 50262

Note

- Counter nut to be used: SKINTOP® GMP-GL-M
- For suitable flat cables, refer to ÖLFLEX® LIFT F for indoor applications or ÖLFLEX® CRANE F for outdoor applications

Technical data

	Classification ETIM 5.0 Class-ID: EC000441 ETIM 5.0 Class-Description: Cable screw gland
	Caution The installation dimensions can be found in appendix T21
	Colour delivered Light grey (RAL 7035)
	Material Body: Polyamide Special sealing insert: CR
	Protection rating IP 54
	Temperature range -30°C to +80°C

Article number	Article designation / size	Min./max. flat cable width	Min./max. cable thickness (mm)	SW1/SW2 mm	Overall length, C (mm)	Thread length, D (mm)	Pieces / PU
SKINDICHT® SVFK-M							
52107900	SVFK-M 25 x 1,5	- / 15.0	-- 5.0	27 / 23	41.0	11	25
52107901	SVFK-M 32 x 1,5	10.0 / 21.0	3.0 - 8.0	36 / 30	39.0	10	25
52107902	SVFK-M 40 x 1,5	16.0 / 28.0	4.0 - 11.5	42 / 40	44.0	11	25
52107903	SVFK-M 50 x 1,5	26.0 / 35.0	4.0 - 11.5	53 / 50	50.5	11	5
52107904	SVFK-M 50 x 1,5	30.0 / 40.0	5.0 - 12.0	60 / 55	53.5	11	5
52107905	SVFK-M 63 x 1,5	36.0 / 45.0	5.0 - 12.0	65 / 60	54.5	11	5

Photographs are not to scale and do not represent detailed images of the respective products.



SKINDICHT® SVF-M

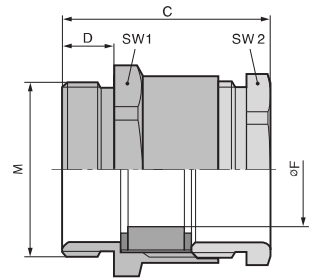

Benefits

- Lateral sealing lips fit automatically around various cable dimensions
- Cable-specific seal dimensions are no longer necessary
- Large opening allows clamping of up to two flat cables
- Optimum strain relief
- Tolerance

Application range

- For inserting flat cables
- Control cabinet manufacturing
- Conveyor systems
- Pumps
- Lifts

Product Make-up

- Metric connection thread acc. to DIN EN 60423
- Basis for technical information EN 50262

Note

- For suitable flat cables, refer to ÖLFLEX® LIFT F for indoor applications or ÖLFLEX® CRANE F for outdoor applications
- Counter nut to be used: SKINDICHT® SM-M

Technical data

- Classification**
ETIM 5.0 Class-ID: EC000441
ETIM 5.0 Class-Description: Cable screw gland
- Caution**
The installation dimensions can be found in appendix T21
- Material**
Body: nickel-plated brass
Seal: CR
- Protection rating**
IP 54
- Temperature range**
-30°C to +100°C

Article number	Article designation / size	Min./max. flat cable width	Min./max. cable thickness (mm)	Pieces / PU
SKINDICHT® SVF-M				
52107320	M 20/16	- / 15.0	- / 5	25
52107340	M 25/21	9.0 / 20.0	3 / 8	25
52107350	M 32/29	14.0 / 27.0	4 / 11	10
52107360	M 40/36	24.0 / 34.0	4 / 11	10
52107370	M 50/42	29.0 / 44.0	5 / 12	5
52107380	M 63/48	34.0 / 50.0	5 / 12	5

Photographs are not to scale and do not represent detailed images of the respective products.

ÖLFLEX®
UNITRONIC®
ETHERLINE®
HITRONIC®
EPIC®
SKINTOP®
SILVYN®
FLEXIMARK®
ACCESSORIES
APPENDIX



SKINDICHT® SKZ-M

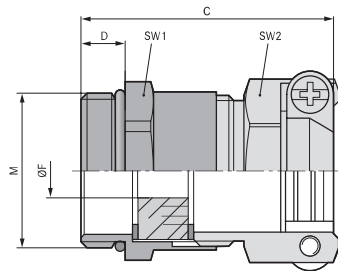

Benefits

- With incised sealing ring for adjustment to several cable diameters
- High strain relief
- High mechanical stability

Application range

- Saddle clamp strain relief gland for harsh application conditions.
- Building sites
- Plant engineering
- Electric motor manufacturing

Product Make-up

- Metric connection thread acc. to DIN EN 60423
- Basis for technical information EN 50262

Note

- SKINDICHT® SHZ-M-XL is similar to the SKINDICHT® SHZ-M, but has an extended connection thread for thick walls
- Counter nut to be used: SKINDICHT® SM-M
- Example description:
SKZ-M 16/9
16 = connection thread
9 = PG function thread

Technical data



Classification

ETIM 5.0 Class-ID: EC000441
ETIM 5.0 Class-Description:
Cable screw gland



Caution

The installation dimensions can be found in appendix T21



Material

Body: nickel-plated brass
Incised sealing ring: CR/NBR
O-ring: NBR



Protection rating

IP 55



Temperature range

-20°C to +80°C

Article number	Article designation / size	Ø-F mm	Max. fitting size for installation (mm)	Function thread PG	SW1/SW2 mm	Overall length, C (mm)	Thread length, D (mm)	Pieces / PU
SKINDICHT® SKZ-M								
52106800	16 x 1,5	5.0 - 8.0	24	9	18 / 17	29.0	5	50
52106810	20 x 1,5	7.0 - 12.0	27	11	22 / 20	30.0	6	50
52106820	20 x 1,5	11.0 - 13.0	30	13.5	22 / 22	33.5	6	25
52106830	20 x 1,5	13.0 - 15.0	33	16	24 / 24	34.5	6	25
52106840	25 x 1,5	16.0 - 19.3	42	21	30 / 30	41.0	7	25
52106850	32 x 1,5	19.0 - 27.0	58	29	40 / 41	46.0	8	10
SKINDICHT® SKZ-M-XL								
52106805	16 x 1,5	5.0 - 8.0	24	9	18 / 17	34.0	10	50
52106815	20 x 1,5	7.0 - 12.0	27	11	22 / 20	34.0	10	50
52106825	20 x 1,5	11.0 - 13.0	30	13.5	22 / 22	37.5	10	25
52106835	20 x 1,5	13.0 - 15.0	33	16	24 / 24	38.5	10	25
52106845	25 x 1,5	16.0 - 19.3	42	21	30 / 30	45.0	11	25
52106855	32 x 1,5	19.0 - 27.0	58	29	40 / 41	51.0	13	10

Photographs are not to scale and do not represent detailed images of the respective products.

Accessories

- SKINDICHT® E refer to page 826
- SKINDICHT® EV refer to page 827



SKINDICHT® SHZ-M

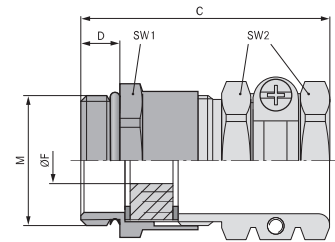

Benefits

- With incised sealing ring for adjustment to several cable diameters
- High strain relief
- Robust
- For cables with large outer diameters

Application range

- Compact brass cable gland for reliable strain relief, solid, for large cable diameters.

Product Make-up

- Metric connection thread acc. to DIN EN 60423
- Basis for technical information EN 50262

Note

- SKINDICHT® SHZ-M-XL is similar to the SKINDICHT® SHZ-M, but has an extended connection thread for thick walls
- Counter nut to be used: SKINDICHT® SM-M
- Example description:
SHZ-M 16/9
16 = metric connection thread
9 = PG function thread

Technical data

- ETIM** Classification
ETIM 5.0 Class-ID: EC000441
ETIM 5.0 Class-Description:
Cable screw gland
- Caution**
The installation dimensions can be found in appendix T21
- Material**
Body: nickel-plated brass
Sealing ring: CR/NBR
O-ring: NBR
- IP** Protection rating
IP 55
- Temperature range**
-20°C to +80°C

Article number	Article designation / size	Ø-F mm	Max. fitting size for installation (mm)	Function thread PG	SW1/SW2 mm	Overall length, C (mm)	Thread length, D (mm)	Pieces / PU
SKINDICHT® SHZ-M								
52106700	12 x 1,5	5.5 - 6.5	21	7	14 / 15	30.0	5	50
52106710	16 x 1,5	5.0 - 8.0	25	9	18 / 17	33.0	5	50
52106720	20 x 1,5	8.0 - 12.0	28	11	22 / 20	35.0	6	25
52106730	20 x 1,5	8.5 - 13.0	32	13.5	22 / 22	39.5	6	25
52106740	20 x 1,5	8.0 - 15.0	35	16	24 / 24	41.5	6	25
52106750	25 x 1,5	14.0 - 19.3	46	21	30 / 30	47.0	7	25
52106760	32 x 1,5	19.0 - 27.0	58	29	40 / 41	53.0	8	10
52106770	40 x 1,5	27.0 - 34.0	70	36	50 / 50	60.0	8	10
52106780	50 x 1,5	35.0 - 43.0	78	42	57 / 57	65.0	9	5
52106790	63 x 1,5	40.0 - 47.5	86	48	66 / 64	68.0	10	5
SKINDICHT® SHZ-M-XL								
52106705	12 x 1,5	5.5 - 6.5	21	7	14 / 15	35.0	10	50
52106715	16 x 1,5	5.0 - 8.0	25	9	18 / 17	38.0	10	50
52106725	20 x 1,5	8.0 - 12.0	28	11	22 / 20	39.0	10	25
52106735	20 x 1,5	8.5 - 13.0	32	13.5	22 / 22	43.5	10	25
52106745	20 x 1,5	9.0 - 14.5	35	16	24 / 24	45.5	10	25
52106755	25 x 1,5	14.0 - 19.3	46	21	30 / 30	51.0	11	25
52106765	32 x 1,5	19.0 - 27.0	58	29	40 / 41	58.0	13	10
52106775	40 x 1,5	27.0 - 34.0	70	36	50 / 50	67.0	13	10
52106785	50 x 1,5	35.0 - 43.0	78	42	57 / 57	70.0	14	5
52106795	63 x 1,5	40.0 - 47.5	86	48	66 / 64	73.0	14	5

Photographs are not to scale and do not represent detailed images of the respective products.

Accessories

- SKINDICHT® E refer to page 826
- SKINDICHT® EV refer to page 827



SKINDICHT® SR-M

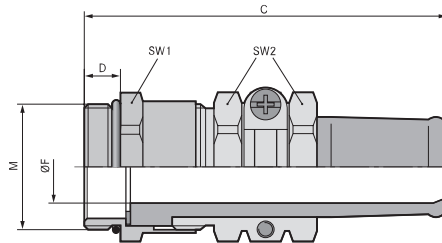

Benefits

- Reliable bending and anti-kink protection
- High strain relief
- Robust
- For cables with large outer diameters
- High degree of protection

Application range

- Cables for electrical appliances and machinery that are moved under normal use must be protected against excessive bending as required in accordance with VDE 0700-1
- Handheld device
- Portable equipment
- Building sites
- Moving machine parts

Product Make-up

- Metric connection thread acc. to DIN EN 60423
- Basis for technical information EN 50262

Note

- Counter nut to be used: SKINDICHT® SM-M
- For EMC version, refer to SKINDICHT® SRE-M
- Example description:
SR-M 12/7/5
12 = metric connection thread
7 = PG function thread
5 = clear opening of seal

Technical data

- Classification**
ETIM 5.0 Class-ID: EC000441
ETIM 5.0 Class-Description:
Cable screw gland
- Caution**
The installation dimensions can be found in appendix T21
- On request**
Available with long connection thread
- Material**
Metal parts: nickel-plated brass
O-ring: NBR
Anti-kink protection: CR/NBR
- Protection rating**
IP 65
- Temperature range**
-20°C to +80°C

Article number	Article designation / size	Clamping range ØF (mm)	Max. fitting size for installation (mm)	Function thread PG	SW1/SW2 mm	Overall length, C (mm)	Thread length, D (mm)	Clear opening F (mm)	Pieces / PU
SKINDICHT® SR-M									
52106410	12 x 1,5	4 - 5	23	7	14 / 15	49.0	5	5	50
52106420	16 x 1,5	5.5 - 7	25	9	18 / 17	50.0	5	7	50
52106430	20 x 1,5	5.5 - 7	28	11	22 / 20	55.0	6	7	25
52106440	20 x 1,5	7.5 - 9	28	11	22 / 20	55.0	6	9	25
52106450	20 x 1,5	7.5 - 9	32	13.5	22 / 22	60.0	6	9	25
52106460	20 x 1,5	9 - 11	32	13.5	22 / 22	60.0	6	11	25
52106470	20 x 1,5	11 - 13	32	13.5	22 / 22	60.0	6	13	25
52106480	20 x 1,5	12 - 13	35	16	24 / 24	65.0	6	13	25
52106481	20 x 1,5	13 - 15	35	16	24 / 24	66.0	6	15	25
52106490	25 x 1,5	12.5 - 15	46	21	30 / 30	78.5	7	15	25
52106500	25 x 1,5	14 - 17	46	21	30 / 30	78.5	7	17	25
52106510	25 x 1,5	17 - 19	46	21	30 / 30	78.5	7	19	25
52106520	25 x 1,5	17 - 20	46	21	30 / 30	78.5	7	20	25
52106530	32 x 1,5	19 - 20	59	29	40 / 41	90.5	8	20	10
52106540	32 x 1,5	22 - 23	59	29	40 / 41	90.5	8	23	10
52106550	32 x 1,5	23 - 25	59	29	40 / 41	90.5	8	25	10
52106560	40 x 1,5	24 - 26	70	36	50 / 50	108.0	8	26	5
52106570	40 x 1,5	28 - 30	70	36	50 / 50	108.0	8	30	5
52106580	40 x 1,5	31 - 33	70	36	50 / 50	108.0	8	33	5
52106590	40 x 1,5	33 - 34.5	70	36	50 / 50	108.0	8	35	5
52106600	50 x 1,5	31 - 34.5	75	42	57 / 57	111.0	9	35	5
52106610	50 x 1,5	32 - 38	75	42	57 / 57	111.0	9	38	5
52106620	50 x 1,5	37 - 40	75	42	57 / 57	111.0	9	40	5
52106630	63 x 1,5	32 - 40	83	48	66 / 64	118.0	10	40	1
52106640	63 x 1,5	36 - 44	83	48	66 / 64	118.0	10	44	1

Photographs are not to scale and do not represent detailed images of the respective products.

Accessories

- SKINDICHT® SM-M refer to page 763
- SKINDICHT® SNR refer to page 832



SKINDICHT® SR-SV-M

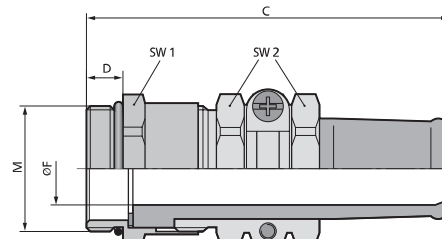

Benefits

- For high temperatures
- Resistant to oils, solvents, acids and chemicals
- Seawater-resistant
- High strain relief
- Robust

Application range

- Cables for electrical appliances and machinery that are moved under normal use must be protected against excessive bending as required in accordance with VDE 0700-1
- Special cable gland with VITON® anti-kink sleeve. Our own reinforced acid-resistant VITON® receptacle does not show any effects of aging even after an extended period of use at a temperature of +165°C.
- Machine and turbine manufacturing
- Power plant engineering
- Laboratory

Product Make-up

- Metric connection thread acc. to DIN EN 60423
- Basis for technical information EN 50262

Note

- Counter nut to be used: SKINDICHT® SM-M
- EMC version is available upon request
- Example description:
SR-SV-M 20/11/7
20 = metric connection thread
11 = PG function thread
7 = clear opening of seal

Technical data

- Classification**
ETIM 5.0 Class-ID: EC000441
ETIM 5.0 Class-Description: Cable screw gland
- Caution**
The installation dimensions can be found in appendix T21
- On request**
Available with long connection thread
- Material**
Body: nickel-plated brass
O-ring: FKM
Anti-kink protection: FKM
- Protection rating**
IP 65
- Temperature range**
-15°C to +165°C

Article number	Article designation / size	Clamping range ØF (mm)	Max. fitting size for installation (mm)	Function thread PG	SW1/SW2 mm	Overall length, C (mm)	Thread length, D (mm)	Clear opening F (mm)	Pieces / PU
SKINDICHT® SR-SV-M									
52105820	20 x 1,5	5.5 - 7	28	11	22 / 20	56.0	6	7	25
52105830	20 x 1,5	7.5 - 9	28	11	22 / 20	56.0	6	9	25
52105840	20 x 1,5	7.5 - 9	32	13.5	22 / 22	61.5	6	9	25
52105850	20 x 1,5	8.5 - 11	32	13.5	22 / 22	61.5	6	11	25
52105860	20 x 1,5	10.5 - 13	32	13.5	22 / 22	61.5	6	13	25
52105870	20 x 1,5	11 - 13	35	16	24 / 24	66.5	6	13	10
52105880	20 x 1,5	12 - 15	35	16	24 / 24	66.5	6	15	10
52105890	25 x 1,5	13.5 - 15	40	21	30 / 30	79.0	7	15	10
52105900	25 x 1,5	15.5 - 17	46	21	30 / 30	79.0	7	17	10
52105910	25 x 1,5	16.5 - 19	46	21	30 / 30	79.0	7	19	10

Viton® is a registered trademark of DuPont de Nemours
Photographs are not to scale and do not represent detailed images of the respective products.

Accessories

- SKINDICHT® SM-M refer to page 763



SKINDICHT® SHVE-M

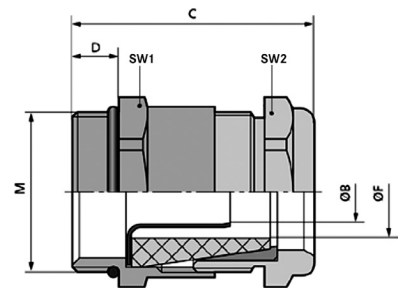
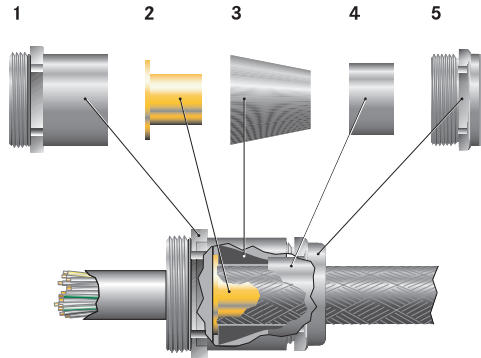

Benefits

- Optimum, low-resistance 360° screen contact
- High degree of protection
- High strain relief

Application range

- Earthing gland, for applications where electrical interference fields can occur.
- Medical engineering
- Frequency converters
- Airports
- Measurement and control technology

Product Make-up

- 1 fitting
- 2 earth sleeves
- 3 sealing cones
- 4 cone, brass
- 5 compression screws

Note

- SKINDICHT® SM-PE-M counter nut should be used to ensure optimum contact with painted, anodised or powder-coated housings
- For more EMC cable glands, refer to SKINTOP® MS-SC-M and MS-M BRUSH, and compatible counter nut SKINDICHT® SM-PE-M
- Example order identification:
SHVE-M 20 / 16 / 15 / 11
20 = Connection thread metric
16 = Function thread PG
15 = Clear width of sealing cone
11 = Clear width of earthing sleeve

Technical data

Classification
ETIM 5.0 Class-ID: EC000441
ETIM 5.0 Class-Description: Cable screw gland

Caution
The installation dimensions can be found in appendix T21

Material
Body: nickel-plated brass
Earthing sleeve: blank brass
Sealing cone: CR
O-ring: NBR

Protection rating
IP 68 - 10 bar

Temperature range
-20°C to +80°C

Article number	Article designation / size	Function thread PG	Outer sheath clamping range ØF (mm)	Inner sheath clamping range (mm)	SW1/SW2 mm	Overall length, C (mm)	Thread length, D (mm)	Clear opening earthing sleeve ØB	Clear opening F (mm)	Pieces / PU
SKINDICHT® SHVE-M										
52106860	16 x 1,5	9	4,5 - 5,8	2,2 - 3,11	18 / 17	26.5	5	3.2	6	25
52106870	16 x 1,5	9	4,5 - 6,8	2,2 - 3,23	18 / 17	26.5	5	3.2	7	25
52106880	16 x 1,5	9	5,5 - 5,8	2,6 - 3,17	18 / 17	26.5	5	3.6	6	25
52106890	16 x 1,5	9	5,5 - 6,8	2,6 - 3,67	18 / 17	26.5	5	3.6	7	25
52106910	20 x 1,5	11	3 - 6,8	3,5 - 4,52	22 / 20	31.0	6	4.5	7	25
52106920	20 x 1,5	11	6 - 8,8	3,5 - 4,45	22 / 20	31.0	6	4.5	9	25
52106930	20 x 1,5	13.5	6,5 - 8,8	3,5 - 5	22 / 22	32.0	6	5	9	25
52106940	20 x 1,5	13.5	6 - 8,8	4,5 - 5,95	22 / 22	32.0	6	6	9	25
52106950	20 x 1,5	13.5	8 - 10,8	5,5 - 6,92	22 / 22	32.0	6	7	11	25
52106960	20 x 1,5	16	8,5 - 10,8	6 - 7,93	24 / 24	34.5	6	8	11	25
52106970	20 x 1,5	16	10 - 12,8	7 - 9	24 / 24	34.5	6	9	13	25
52106980	20 x 1,5	16	10 - 12,8	8 - 10	24 / 24	34.5	6	10	13	25
52106990	20 x 1,5	16	12,5 - 14,8	9 - 11,03	24 / 24	34.5	6	11	15	25
52107000	25 x 1,5	21	13 - 15,8	10 - 12,15	30 / 30	39.0	7	12	16	25
52107010	25 x 1,5	21	13 - 15,8	11 - 13	30 / 30	39.0	7	13	16	25
52107020	25 x 1,5	21	15,5 - 17,8	12 - 14	30 / 30	39.0	7	14	18	25
52107030	25 x 1,5	21	15 - 17,8	13 - 15	30 / 30	39.0	7	15	18	25
52107040	25 x 1,5	21	17,5 - 19,8	14 - 16	30 / 30	39.0	7	16	20	25
52107050	32 x 1,5	29	19 - 21,8	15 - 17,02	40 / 40	45.5	8	17	22	10
52107060	32 x 1,5	29	18 - 23,8	16 - 18	40 / 40	45.5	8	18	22	10
52107070	32 x 1,5	29	20 - 23,8	17 - 19	40 / 40	45.5	8	19	24	10
52107080	32 x 1,5	29	23 - 25,8	17 - 19	40 / 40	45.5	8	19	26	10

Photographs are not to scale and do not represent detailed images of the respective products.

Accessories

- SKINDICHT® SM-M refer to page 763
- SKINDICHT® SM-PE-M refer to page 763



SKINDICHT® SRE-M

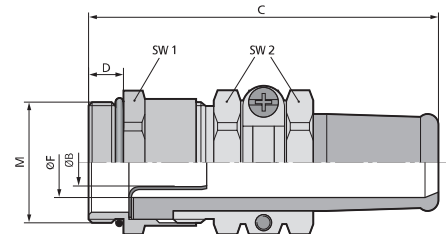

Benefits

- Perfect seal with anti-kink protection
- Optimum, low-resistance 360° screen contact
- Cable-protecting strain relief
- Gentle cable clamping
- High degree of protection

Application range

- Earthing gland with additional anti-kink protection. For applications where electrical interference fields can occur.
- Moving machine parts
- Conveyor and transport systems
- Production lines
- Measurement and control technology

Product Make-up

- Metric connection thread acc. to DIN EN 60423
- Basis for technical information EN 50262

Note

- SKINDICHT® SM-PE-M counter nut should be used to ensure optimum contact with painted, anodised or powder-coated housings
- Example description:
SRE-M 20 / 13.5/9/6
20 = connection thread
13.5 = PG function thread
9 = clear opening of anti-kink sleeve (F)
6 = clear opening of earthing sleeve (B)

Technical data

ETIM **Classification**
ETIM 5.0 Class-ID: EC000441
ETIM 5.0 Class-Description: Cable screw gland

Caution
The installation dimensions can be found in appendix T21

On request
Available with long connection thread

Material
Body: nickel-plated brass
Earthing sleeve: plain brass
Anti-kink sleeve: CR/NBR
O-ring: NBR

IP **Protection rating**
IP 65

Temperature range
-20°C to +80°C

Article number	Article designation / size	Function thread PG	Outer sheath clamping range ØF (mm)	Inner sheath clamping range (mm)	SW1/SW2 mm	Overall length, C (mm)	Thread length, D (mm)	Clear opening earthing sleeve ØB	Clear opening F (mm)	Pieces / PU
SKINDICHT® SRE-M										
52105600	20 x 1,5	13,5	7,5 - 9	4,5 - 6	22 / 22	59,5	6	6	9	25
52105610	20 x 1,5	13,5	9 - 11	5,5 - 7	22 / 22	59,5	6	7	11	25
52105620	20 x 1,5	16	11 - 13	7 - 9	24 / 24	64,5	6	9	13	25
52105630	20 x 1,5	16	11 - 13	8 - 10	24 / 24	64,5	6	10	13	25
52105640	20 x 1,5	16	13,5 - 15	9 - 11	24 / 24	64,5	6	11	15	25
52105650	25 x 1,5	21	13,5 - 15	10 - 12	30 / 30	78,0	7	12	15	25
52105660	25 x 1,5	21	15 - 17	12 - 14	30 / 30	78,0	7	14	17	25
52105670	25 x 1,5	21	17 - 19	13 - 15	30 / 30	78,0	7	15	19	25
52105680	25 x 1,5	21	18 - 20	14 - 16	30 / 30	78,0	7	16	20	25
52105690	32 x 1,5	29	18 - 20	15 - 17	40 / 40	90,0	8	17	20	10
52105700	32 x 1,5	29	21 - 23	17 - 19	40 / 40	90,0	8	19	23	10
52105710	40 x 1,5	36	23,5 - 26	20 - 22	50 / 50	108,0	8	22	26	5
52105720	40 x 1,5	36	27 - 30	22 - 24	50 / 50	108,0	8	24	30	5
52105730	40 x 1,5	36	30 - 33	26 - 28	50 / 50	108,0	8	28	33	5
52105740	40 x 1,5	36	32 - 35	28 - 30	50 / 50	108,0	8	30	35	5

Photographs are not to scale and do not represent detailed images of the respective products.

Accessories

- SKINDICHT® SM-PE-M refer to page 763
- SKINDICHT® SNR refer to page 832

ÖLFLEX®
UNITRONIC®
ETHERLINE®
HITRONIC®
EPIC®
SKINTOP®
SILVYN®
FLEXIMARK®
ACCESSORIES
APPENDIX



SKINDICHT® SHV-M

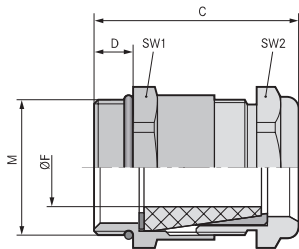

Benefits

- Watertight
- Gentle cable clamping
- Robust
- High strain relief

Application range

- Watertight cable gland with conical sealing element.
- Pumps
- Floater switches

Product Make-up

- Metric connection thread acc. to DIN EN 60423
- Basis for technical information EN 50262

Note

- Suitable accessory: SKINDICHT® SHV sealing cones
- Example description:
SHV-M 20 / 11 / 7
20 = metric connection thread
11 = PG function thread
7 = clear opening of sealing cone

Technical data



Classification

ETIM 5.0 Class-ID: EC000441
ETIM 5.0 Class-Description:
Cable screw gland



Caution

The installation dimensions can be found in appendix T21



Material

Body: nickel-plated brass
Sealing cone: CR
O-ring: NBR



Protection rating

IP 68 - 10 bar



Temperature range

-20 °C to +80 °C

Article number	Article designation / size	Clamping range ØF (mm)	Function thread PG	SW1/SW2 mm	Overall length, C (mm)	Thread length, D (mm)	Clear opening seal	Pieces / PU
SKINDICHT® SHV-M								
52105270	12 x 1,5	3 - 4,8	7	14 / 14	26.0	5	5	50
52105280	16 x 1,5	4,5 - 5,8	9	18 / 17	26.5	5	6	50
52105290	16 x 1,5	4,5 - 6,8	9	18 / 17	26.5	5	7	50
52105300	20 x 1,5	6 - 6,8	11	22 / 20	31.0	6	7	25
52105310	20 x 1,5	6,5 - 8,8	11	22 / 20	31.0	6	9	25
52105320	20 x 1,5	6,5 - 8,8	13.5	22 / 22	32.5	6	9	25
52105330	20 x 1,5	9 - 10,8	13.5	22 / 22	32.5	6	11	25
52105340	20 x 1,5	9 - 10,8	16	24 / 24	34.5	6	11	25
52105350	20 x 1,5	9,5 - 12,8	16	24 / 24	34.5	6	13	25
52105360	20 x 1,5	13 - 14,8	16	24 / 24	34.5	6	15	25
52105370	25 x 1,5	13,5 - 15,8	21	30 / 30	38.5	7	16	25
52105380	25 x 1,5	15 - 17,8	21	30 / 30	38.5	7	18	25
52105390	25 x 1,5	17,5 - 19,8	21	30 / 30	38.5	7	20	25
52105400	32 x 1,5	17,5 - 21,8	29	40 / 40	42.5	8	22	10
52105410	32 x 1,5	19 - 23,8	29	40 / 40	42.5	8	24	10
52105420	32 x 1,5	23 - 25,8	29	40 / 40	42.5	8	26	10

Photographs are not to scale and do not represent detailed images of the respective products.

Accessories

- SKINDICHT® SM-M refer to page 763



SKINDICHT® SHV-M-VITON®

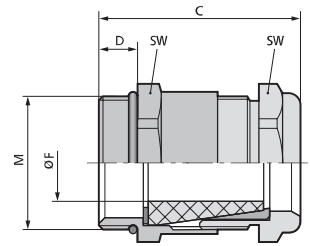

Benefits

- For high temperatures
- Resistant to oils, solvents, acids and chemicals
- Watertight
- High strain relief
- Robust

Application range

- Watertight and high temperature-resistant cable gland with special conical VITON® sealing element
- Brickworks
- Sewage treatment plants
- Car wash sites

Product Make-up

- 1 fitting
- 2 washers
- 3 VITON® sealing cone
- 4 brass cones
- 5 compression screws

Note

- Counter nut to be used: SKINDICHT® SM-M
- Example description:
SHV-M-Viton® 20/11/7
20 = metric connection thread
11 = PG function thread
7 = clear opening of sealing cone

Technical data

Classification
ETIM 5.0 Class-ID: EC000441
ETIM 5.0 Class-Description:
Cable screw gland

Caution
The installation dimensions can be found in appendix T21

Material
Body: nickel-plated brass
Sealing cone: FKM
O-ring: FKM

Protection rating
IP 68 - 10 bar

Temperature range
-15°C to +200°C

Article number	Article designation / size	Clamping range ØF (mm)	Function thread PG	SW wrench size mm	Overall length, C (mm)	Thread length, D (mm)	Clear opening F (mm)	Pieces / PU
SKINDICHT® SHV-M-VITON®								
52105430	12 x 1,5	3,8 - 4,8	7	14 / 14	26,0	5	5	50
52105440	16 x 1,5	4,8 - 5,8	9	18 / 17	27,5	5	6	50
52105450	16 x 1,5	5,8 - 6,8	9	18 / 17	27,5	5	7	50
52105460	20 x 1,5	5,8 - 6,8	11	22 / 20	31,0	6	7	25
52105470	20 x 1,5	6,8 - 8,8	11	22 / 20	31,0	6	9	25
52105480	20 x 1,5	8,5 - 10,8	13,5	22 / 22	32,5	6	11	25
52105490	20 x 1,5	6,8 - 8,8	13,5	22 / 22	32,5	6	9	25
52105500	20 x 1,5	10,8 - 12,8	16	24 / 24	34,5	6	13	25
52105510	20 x 1,5	13,8 - 14,8	16	24 / 24	34,5	6	15	25
52105520	25 x 1,5	15,8 - 17,8	21	30 / 30	38,0	7	18	25
52105530	25 x 1,5	17,5 - 19,8	21	30 / 30	38,0	7	20	25
52105540	32 x 1,5	19,5 - 21,8	29	40 / 40	44,5	8	22	10

Viton® is a registered trademark of DuPont de Nemours
Photographs are not to scale and do not represent detailed images of the respective products.

Accessories

- SKINDICHT® SM-M refer to page 763





SKINDICHT® MINI

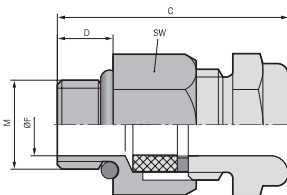

Benefits

- High degree of protection
- For the smallest conductor sizes
- Low height
- Gentle cable clamping
- High packing density

Application range

- For use wherever there is limited assembly space.
- Sensors
- Measuring technology

Technical data

Classification
 ETIM 5.0 Class-ID: EC000441
 ETIM 5.0 Class-Description:
 Cable screw gland

Caution
 Recommendation of torque wrench
 M 6 x 1 1,2 Nm
 M 8 x 1 1,5 Nm

Material
 Body: nickel-plated brass
 Seal: CR/NBR

Protection rating
 IP 68 - 5 bar

Temperature range
 -20°C to +100°C

Article number	Article designation / size	Clamping range ØF (mm)	SW wrench size mm	Overall length, C (mm)	Thread length, D (mm)	Pieces / PU
SKINDICHT® MINI						
52001860	MINI 6 x 1	2 - 3	9	19.5	5	50
52001880	MINI 8 x 1	3,5 - 5,5	11	20.5	5	50
SKINDICHT® MINI counter nut						
52102998	MINI 6 x 1	-	10	11.0	2.5	50
52102997	MINI 8 x 1	-	12	13.5	2.5	50

Photographs are not to scale and do not represent detailed images of the respective products.



SKINDICHT® CN-M

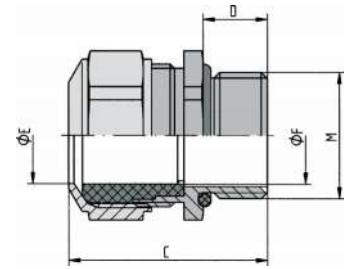

Benefits

- For high temperatures
- Resistant to oils, solvents, acids and chemicals
- Seawater-resistant
- For high mechanical stress
- High corrosion-resistance

Application range

- Chromium nickel steel cable gland with VITON® seal, specially designed for use under tough conditions
- Pharmaceutical and petrochemical industry
- Offshore sector
- Wind power plants
- Brickworks

Product Make-up

- Metric connection thread acc. to DIN EN 60423
- Basis for technical information EN 50262

Note

- Refer to the chart to find a suitable counter-nut for SKINDICHT® SM CrNi M

Technical data

- Classification**
ETIM 5.0 Class-ID: EC000441
ETIM 5.0 Class-Description: Cable screw gland
- Caution**
The installation dimensions can be found in appendix T21
- Material**
Body: chrome-nickel steel in accordance with DIN, material no. 1.4305
Inner seal: FPM
O-ring: FPM
- Protection rating**
IP 68 - 5 bar
- Temperature range**
-40°C to +200°C

Article number	Article designation / size	Clamping range ØF (mm)	SW wrench size mm	Overall length, C (mm)	Thread length, D (mm)	Pieces / PU
SKINDICHT® CN-M						
52032580	12 x 1,5/1	3,5 - 5	17	27.0	10	5
52032590	12 x 1,5/2	5 - 6,5	17	27.0	10	5
52032600	12 x 1,5/3	6,5 - 8	17	27.0	10	5
52032610	16 x 1,5	8 - 10,5	18	30.0	10	5
52032620	20 x 1,5	11 - 15	24	31.0	10	5
52032630	25 x 1,5	16 - 20,5	30	36.0	11	5
52032640	32 x 1,5	21 - 25,5	36	41.0	13	5
52032650	40 x 1,5	28,5 - 33	46	44.0	13	1
52032660	50 x 1,5	37 - 42	55	48.0	14	1
52032670	63 x 1,5	46 - 52	70	51.0	14	1
SKINDICHT® SM CrNi M counter nuts						
52032585	12 x 1,5	-	17	3.0	3	10
52032615	16 x 1,5	-	19	3.0	3	10
52032625	20 x 1,5	-	24	3.5	3.5	10
52032635	25 x 1,5	-	30	3.5	3.5	10
52032645	32 x 1,5	-	36	4.5	4.5	10
52032655	40 x 1,5	-	46	4.5	4.5	10
52032665	50 x 1,5	-	55	5.5	5.5	10
52032675	63 x 1,5	-	70	6.0	6	10

Viton® is a registered trademark of DuPont de Nemours
Photographs are not to scale and do not represent detailed images of the respective products.



SKINDICHT® KW-M

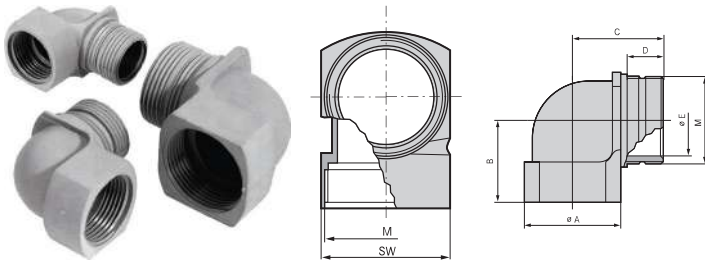

Benefits

- Space- and weight-saving application due to thin cable diameters
- Decrease in installation height

Application range

- Angled glands are used in areas where cables have to run in parallel to the housing wall.
- Light and sound applications
- Control cabinet manufacturing

Product Make-up

- Metric connection thread acc. to DIN EN 60423
- Basis for technical information EN 50262

Note

- Refer to SKINDICHT® O-ring Perbunan® for suitable O-rings
- SKINDICHT® KW-M can be combined with any cable gland, in particular with SKINTOP® ST-M
- Counter nut to be used: SKINTOP® GMP-GL-M
- In combination with SKINTOP® ST-M the degree of protection is IP 68 (acc. technical description)

Technical data

ETIM	Classification ETIM 5.0 Class-ID: EC000441 ETIM 5.0 Class-Description: Cable screw gland
RAL	Colour delivered Silver grey (RAL 7001)
Material	Polyamide, glass fibre-reinforced
IP	Protection rating IP 55
Temperature range	-20°C to +80°C

Article number	Article designation / size	A (mm)	B in mm	Ø E mm	SW wrench size mm	Overall length, C (mm)	Thread length, D (mm)	Pieces / PU
SKINDICHT® KW-M								
52106210	16 x 1,5	19	21.5	11	19	24.0	13	25
52106220	20 x 1,5	25	24.5	15	25	29.5	15	25
52106230	25 x 1,5	30	28	20	30	33.5	16	25
52106240	32 x 1,5	36	31.5	26	36	38.0	17	10

Perbunan® is a registered trademark of BAYER AG
Photographs are not to scale and do not represent detailed images of the respective products.



SKINDICHT® RWV-M

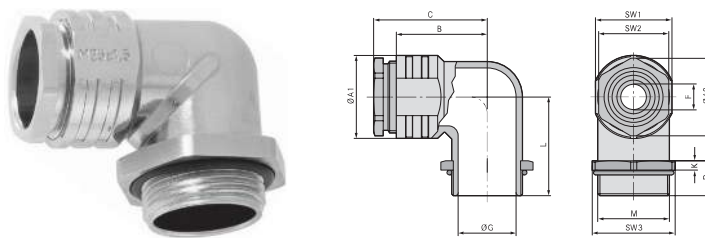

Benefits

- Strain relief
- Sealed by incised sealing ring
- Corrosion-resistant
- Decrease in installation height
- Seawater-resistant

Application range

- Angled glands are used in areas where cables have to run in parallel to the housing wall.
- Electric motor manufacturing

- Machine and equipment manufacturing
- Plant engineering
- Light and sound applications

Product Make-up

- Metric connection thread acc. to DIN EN 60423
- Basis for technical information EN 50262

Note

- Counter nut to be used: SKINDICHT® SM-M

Technical data

ETIM	Classification ETIM 5.0 Class-ID: EC000441 ETIM 5.0 Class-Description: Cable screw gland
Material	Body: zinc die-casting, nickel-plated Compression screw and hexagon nut: nickel-plated brass Incised sealing ring: CR/NBR O-ring: NBR
IP	Protection rating IP 55
Temperature range	-20°C to +100°C

Article number	Article designation / size	Clamping range ØF (mm)	L	SW1	Ø A1	SW2	Ø A2	Ø G	Height (mm)	Overall length, C (mm)	Thread length, D (mm)	SW3	Pieces / PU
SKINDICHT® RWV-M													
52107800	12 x 1,5	5	20.5	14	16	12	13.2	8	5	26.1	11.5	17	25
52107810	16 x 1,5	9 - 3	23.5	18	20	16	17.6	12	5	28.6	11.5	22	25
52107820	20 x 1,5	13 - 4	28.5	22	24	20	22.2	15	5	35.1	12.5	27	25
52107830	25 x 1,5	17.5 - 8.5	31	27	29	25	27.5	20	5	38.1	13.5	32	10
52107840	32 x 1,5	25 - 16	33	34	36	32	35.2	27	5	44.6	13.5	41	10
52107850	40 x 1,5	32 - 23	43	42	45	40	43.5	35	5	53.1	15.5	46	5

Photographs are not to scale and do not represent detailed images of the respective products.



SKINDICHT® RWV-M without E+D

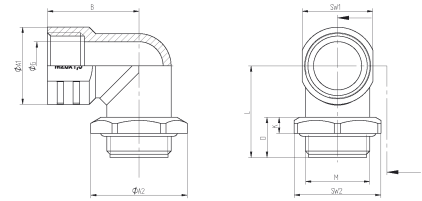

Benefits

- Combination of different conduit glands is possible
- Space- and weight-saving application due to thin cable diameters
- Decrease in installation height
- Cable runs parallel to the housing wall
- Corrosion-resistant

Application range

- Angled glands are used in areas where cables have to run in parallel to the housing wall.
- Electric motor manufacturing
- Machine and equipment manufacturing
- Plant engineering
- Light and sound applications

Product Make-up

- Metric connection thread acc. to DIN EN 60423
- Basis for technical information EN 50262

Note

- The protection class is dependent on the combination with the various special glands. The minimum standard is IP 55.
- Counter nut to be used: SKINDICHT® SM-M
- Cable glands are not included in scope of delivery

Technical data

- Classification**
ETIM 5.0 Class-ID: EC000441
ETIM 5.0 Class-Description: Cable screw gland
- Material**
Body: zinc die-casting
Hexagon nut: nickel-plated brass
O-ring: NBR
- Protection rating**
IP 55
- Temperature range**
-20°C to +100°C

Article number	Article designation / size	B in mm	Thread length, D (mm)	K	L	Ø G	SW1	Ø A1	SW2	Ø A2	Pieces / PU
SKINDICHT® RWV-M without E+D											
52107801	12 x 1,5	21	11.5	5	21	8	14	16	17	18.9	25
52107811	16 x 1,5	23	11.5	5	24	12	18	20	22	24.5	25
52107821	20 x 1,5	28.5	12.5	5	29	15	22	24	27	30.1	25
52107831	25 x 1,5	30	13.5	5	31	20	27	29	32	35.7	10
52107841	32 x 1,5	33.5	13.5	5	33	27	34	33.5	41	45.6	10
52107851	40 x 1,5	43	15.5	5	43	35	42	43	46	50.6	5

Photographs are not to scale and do not represent detailed images of the respective products.



SKINDICHT® SE-M

Benefits

- Sealed by incised sealing ring
- Corrosion-resistant
- Easy to install
- Completely safe cable entry
- Low overall height

Application range

- For high mechanical stress
- When no connection thread is provided

Product Make-up

- M20 x 1.5 - M25 x 1.5 with 2 screw holes
- M32 x 1.5 with 4 screw holes
- With incised sealing ring

Note

- Drawing on request

Technical data

- Classification**
ETIM 5.0 Class-ID: EC000441
ETIM 5.0 Class-Description: Cable screw gland
- Material**
Body: zinc die-casting, grey, hammer tone finish
Compression screw: nickel-plated brass
Incised sealing ring: CR/NBR
O-ring: NBR
- Protection rating**
IP 55
- Temperature range**
-20°C to +80°C



Article number	Article designation / size	Incised sealing ring ØF (mm)	Overall height (mm)	SW wrench size mm	Overall length, C (mm)	Overall width (mm)	Pieces / PU
SKINDICHT® SE-M							
52108000	M 20 x 1,5	4/7/10/13	31	20	49.2	42	10
52108010	M 25 x 1,5	8.5/11.5/14.5/17.5	40	25	68.2	60	5
52108020	M 32 x 1,5	16/19/22/25	51.5	32	84.2	66	1

Photographs are not to scale and do not represent detailed images of the respective products.



SKINDICHT® SE-M without E+D



Benefits

- Combination of different conduit glands is possible
- Corrosion-resistant
- Easy to install
- Completely safe cable entry
- Low overall height

Application range

- The flange angle gland can be combined with all glands (including O-ring) e.g. strain relief, bending protection and conduit glands
- For high mechanical stress
- When no connection thread is provided

Product Make-up

- M20 x 1.5 - M25 x 1.5 with 2 screw holes
- M32 x 1.5 with 4 screw holes

Note

- The protection class is dependent on the combination with the various special glands. The minimum standard is IP 55.
- Cable glands are not included in scope of delivery
- Drawing on request

Technical data

Classification
ETIM 5.0 Class-ID: EC000441
ETIM 5.0 Class-Description:
Cable screw gland

Material
Body: zinc die-casting, grey, hammer tone finish
O-ring: NBR

Protection rating
IP 55

Temperature range
-20°C to +100°C

Article number	Article designation / size	Height (mm)	Overall width (mm)	Length (mm)	PU
SKINDICHT® SE-M without E+D					
52108001	20 x 1,5	31	42	42.0	10
52108011	25 x 1,5	40	60	60.0	5
52108021	32 x 1,5	51.5	66	76.0	1

Photographs are not to scale and do not represent detailed images of the respective products.



SKINDICHT® SE-M 220/320



Benefits

- Combination of various conduit glands is possible depending on the type
- Low overall height
- High stability
- Two or three separate cable outlets

Application range

- For high mechanical stress
- When no connection thread is provided

Note

- Type SKINDICHT® SE-M 220/320 without E+D is without incised sealing ring and without compression screw
- Type SKINDICHT® SE-M 220/320 without E+D can be combined with all cable glands (incl. O-ring) such as sealing, strain-relief, anti-kink, conduit-connecting or earthing glands

Technical data

Classification
ETIM 5.0 Class-ID: EC000441
ETIM 5.0 Class-Description:
Cable screw gland

Material
Body: zinc die-casting, hammer tone finish
Compression screw: nickel-plated brass
Incised sealing ring: CR/NBR
Flat sealing ring: SBR

Protection rating
IP 55

Temperature range
-20°C to +80°C

- The protection class is dependent on the combination with the various special glands. The minimum standard is IP 55.
- Drawing on request

Article number	Article designation / size	Incised sealing ring ØF (mm)	Pieces / PU
SKINDICHT® SE-M 220/320			
52108040	2 x M20 x 1,5	2 x 4/7/10/13	1
52108050	3 x M20 x 1,5	3 x 4/7/10/13	1
SKINDICHT® SE-M 220/320 without E+D			
52108041	2 x M20 x 1,5		1
52108051	3 x M20 x 1,5		1

Photographs are not to scale and do not represent detailed images of the respective products.