

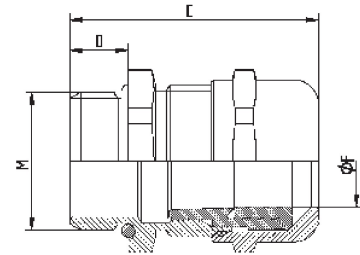

SKINTOP® MS-HF-M

Info

- Cable gland for railway applications
- Hazard Level: HL 3



Benefits

- Halogen-free and flame-retardant
- Optimum strain relief
- Wide, variable clamping ranges
- Maximum reliability

Application range

- Underground railways and trains
- In areas where mechanical and chemical stability are critical
- When the protection of people and property is a priority

Norm references / Approvals

- DIN EN 45545-2 (HL3)
- DIN EN 45545-3 (E30)

Product Make-up

- Metric connection thread acc. to DIN EN 60423
- Basis for technical information DIN IEC 62444

Suitable tools

- SKINMATIC® QUICK Set 1 refer to page 809
- SKINMATIC® MH Set refer to page 809
- SKINMATIC® RZ refer to page 810

Technical data

Classification ETIM 5/6
 ETIM 5.0/6.0 Class-ID: EC000441
 ETIM 5.0/6.0 Class-Description: Cable screw gland

Caution
 Refer to Appendix T21 for the installation dimensions and torques

Material
 Body: nickel-plated brass
 Insert: halogenfree polyamide acc. to UL 94 V0
 Sealing: special elastomere
 O-ring: special elastomere

IP
 IP 68 - 5 bar

Temperature range
 Dynamic: -25°C up to + 100°C
 Fixed: -40°C to +100°C

Article number	Article designation / size	Ø F mm	SW wrench size mm	Overall length C mm	Thread length D mm	Pieces / PU
SKINTOP® MS-HF-M						
53112570	M 12 x 1,5	3,5-7	16	26,5	6,5	100
53112571	M 16 x 1,5	4,5-10	20	33,0	7	100
53112572	M 20 x 1,5	7-13	24	37,0	8	50
53112573	M 25 x 1,5	9-17	29	38,5	8	25
53112574	M 32 x 1,5	11-21	36	45,5	9	25
53112575	M 40 x 1,5	19-28	45	48,0	9	10
53112576	M 50 x 1,5	27-35	54	55,5	10	5
53112577	M 63 x 1,5	34-45	67	67,0	15	5

Photographs and graphics are not to scale and do not represent detailed images of the respective products.

Accessories

- SKINDICHT® SM-M refer to page 742